

- 1 Power switch 2 Status indicator 3 Bluetooth pairing button
4 USB port 5 Flymagic interface 6 Power port



With Flydigi's patented innovation, dual functionalities can be achieved in just one port!

Function 1 activate button Flymapping

Function 2 extend keyboard/mouse connection

Controller connection instructions

Step 1: Download Flydigi Controller Assistant



Scan QR code to install Flydigi Gamepad Assistant
(For Android users, please download Flymagic version)

Or use browser to visit Flydigi official website to download: <https://www.flydigi.com>

Step 2: Connect to cellphone using Bluetooth

1. For first-time use, connect to 5V power, turn the converter power switch to "ON", then controller goes into Bluetooth pairing mode with indicator flashing quickly in blue.

2. Click on phone settings -> Bluetooth



Turn on phone Bluetooth, search and connect to FeizhiQ1 Indicator will stay steadily in blue after successfully connected

Note: For paired converter, it will automatically search and reconnect to the cellphone it connected lasted time after being disconnected from power and restarted, while in the reconnecting process, indicator will flash slowly in blue; if cellphone connection needs to be changed, it is needed to cancel previous cellphone pairing or turn off Bluetooth, then press Bluetooth pairing button for over 5 seconds, while indicator flashing quickly in blue after it goes out

Step 3: Activate Flymapping button cloud mapping

For Android devices only

Turn on USB debugging mode on phone according to Flydigi Gamepad Assistant - button mapping activation guide, and complete the following steps



Use data cable provided with cellphone to connect phone and converter, as shown in the figure

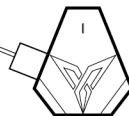

Allow USB debugging?

The computer's RSA key fingerprint is:
C7:8B:CC:19:7B:28:74:97:29:C8:8E:96:EA:5B:18:D7

☒ Always allow from this computer

Cancel OK

When USB debugging authorization pop-up shows up on the cellphone, select OK. After activation is successful, indicator will stay steadily in orange. Data cable can be disconnected at this time, while indicator will stay steadily in blue instead

Note: Only Flymagic port supports button cloud mapping activation, please make sure connection is correct

Step 4: Connect keyboard and mouse

Flydigi controller assistant will prompt "keyboard and mouse are connected" after connecting converter with USB keyboard and mouse, as shown in figure below

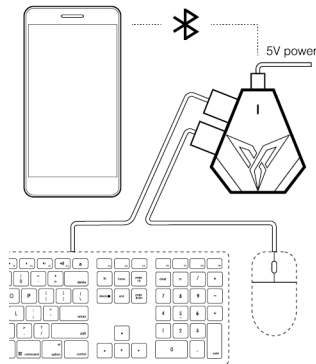

Note: keyboard/mouse extension supports USB keyboard and mouse devices, including USB wired keyboard and mouse, wireless keyboard and mouse suite and wireless mouse

Step 5: Launch game

For better gaming experience, please launch game in Flydigi Controller Assistant



Android

Android devices support adding game. Games not downloaded from Flydigi Gamepad Assistant can be added via the "+" sign in "My" and customized

Instructions of basic operations and indicators

Power on/off	Slide the power switch to ON to turn on converter Slide the power switch to OFF to turn off converter	<p>For first time use, indicator [flashes quickly in blue] and enters pairing mode</p> <p>When turned on after pairing is completed, indicator [flashes slowly in blue] and enter reconnection mode</p>
Pairing successful	Converter is successfully connected with cellphone via Bluetooth	Indicator [stays steadily in blue]
Pairing status	Press Bluetooth pairing button for over 5 seconds after turned on	Indicator [flashes quickly in blue] and enters pairing mode again
Activating button mapping	Use data cable provided with phone to connect controller's Flymagic port and Android phone	<p>Under activation mode, indicator [flashes quickly in orange]</p> <p>After activation is successful, indicator [stays steadily in orange for 5 seconds before it goes out]</p>

Performance specifications

Supported platforms	Android	Android phones and tablets with Bluetooth 4.0, while Android system is 4.4 and above
Connection method	Bluetooth 4.0	
Distance of use	Less than 10m	
Power consumption	Operational current ≤2.5mA (with no mouse and keyboard)	
Input voltage	5V	

FAQ

1 What can keyboard/mouse converter do?

Keyboard/mouse converter can connect to cellphone via Bluetooth and then connect keyboard and mouse, so you can control mobile games through them.

2 What if button mapping cannot be activated?

Please confirm whether operation is correct, please refer to button mapping activation wizard in Flydigi Gamepad Assistant for details;
Please use original data cable of the phone for activation operation (charging cables without data transmission function cannot complete activation);

3 Is it a must to use 5V power supply?

Yes, otherwise it may cause damage to converter and keyboard/mouse devices.

4 What are keyboard and mouse types that are supported?

Keyboard/mouse extension supports keyboard and mouse devices with USB port, including USB wired keyboard and mouse, wireless keyboard and mouse suite and wireless mouse.



Web: www.flydigi.com
Facebook: Flydigi



Flydigi Q1 Keyboard&Mouse Converter
for Mobile Game

User Manual